

ELEGANT WITH DECK

Contents of the Accessory box SKU # 1002-HRK

SCREW KIT 140-0006

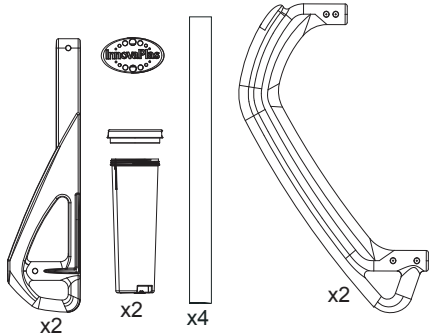
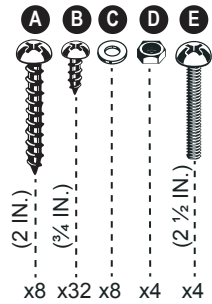

Step Shell

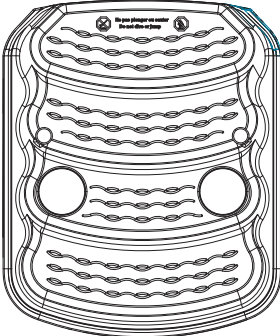

Sand (not included)



⚠ WARNING

- ▶ Install the step on a flat surface.
- ▶ Do not jump or dive from the step or ladder.
- ▶ Remove the step from water when temperatures drop below freezing.
- ▶ In winter, the step should be stored in an area protected from snow.
- ▶ Never lift the step by its handrails.
- ▶ Use BATTERY operated tools to avoid electric shock near water.
- ▶ Ensure no corrosive materials are added to the step or hardware kit.
- ▶ The step must be installed per manufacturer's instructions.
- ▶ File off all stripped or sharp edges before assembly to avoid injuries and liner damage.
- ▶ The manufacturer is not responsible for damages or injuries caused by improper installation or use of product.
- ▶ To ease the installation of handrails and bolts, use a screwdriver to line up the holes.
- ▶ **Maximum weight: 400 lbs / 180 kg.**

Required tools (not included)



A

- 1) Assemble the tubes to the step with the screws, washers and nuts provided.
- 2) Slide the lateral supports over the posts.

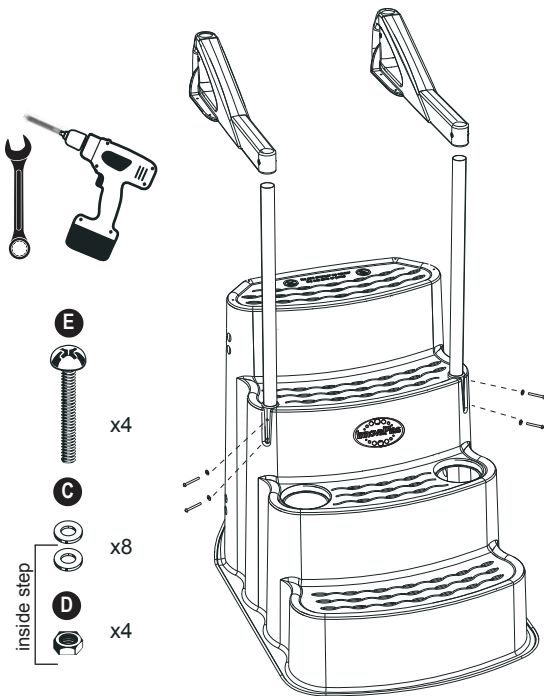

MANUFACTURER WARRANTY

**1 year on pool step.
1 year on hardware.**



2257 route 139
Drummondville, Québec
J2A 2G2

WWW.INNOVAPLAS.COM

REV. 02/07/2023

PN:

PG:1

ELEGANT WITH DECK

B

1) Fill the ballast with sand. The approximate weight should be 15 lbs per ballast.

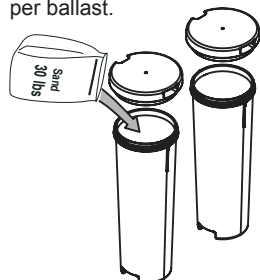

2) Screw the lid in place and align the cover ribs with the holes in the ballast base.



Align holes

3) Fasten the cover to the ballast base with the four screws provided.

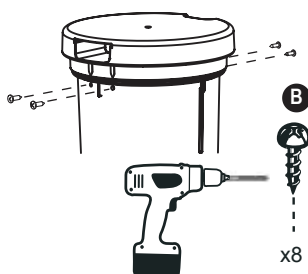

4) Slowly submerge the step into the pool. Make sure you do not damage the pool liner in the process.

5) Angle the whole step so that it is entirely under water. Purge all the air from under the steps.

6) Slide the lateral supports to the height of the deck.

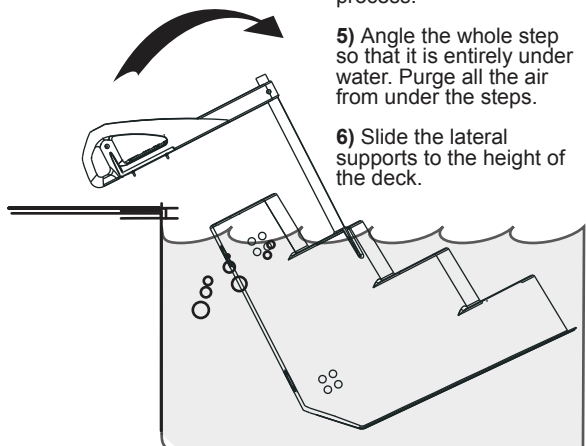

C

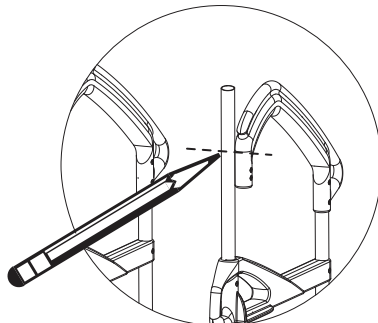
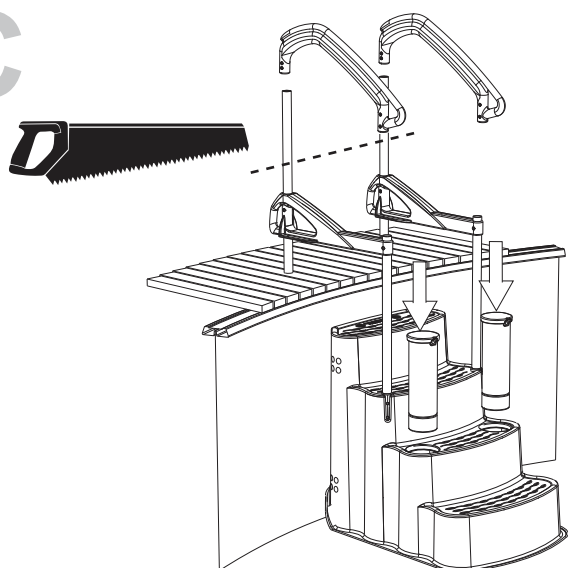

1) Drop the ballasts in the step holes.

2) Insert the rear posts into the lateral supports.

3) Insert the handrails over the two front posts. Mark on the rear posts with a pencil where to cut posts so that they fit in the handrails.

4) Cut the posts.

D

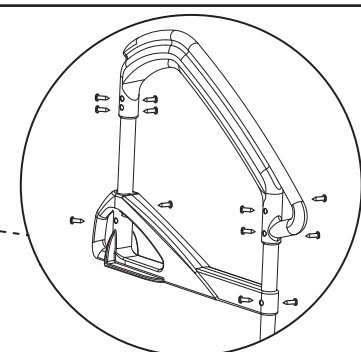
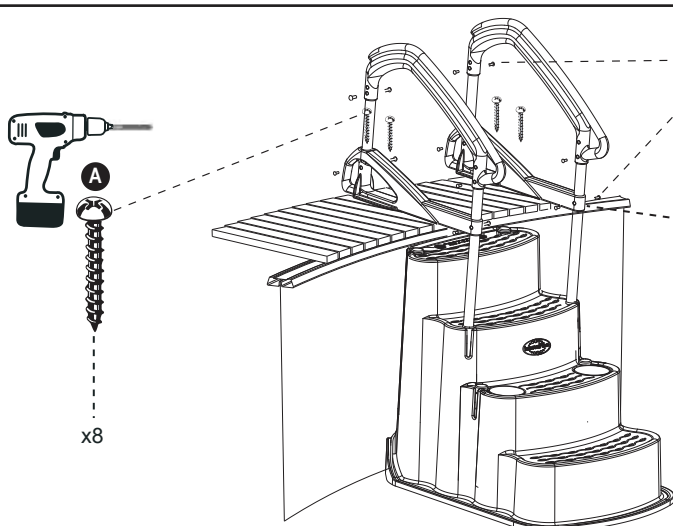

1) Secure the lateral supports and the handrails to the posts using the screws provided.

2) Secure the lateral supports to the deck using the screws provided.



2257 route 139
Drummondville, Québec
J2A 2G2

WWW.INNOVAPLAS.COM

MANUFACTURER WARRANTY

**1 year on pool step.
1 year on hardware.**

REV. 02/07/2023

PN:

PG:2